

GENERAL NOTES

1. THE ACCURACY AND COMPLETENESS OF THIS SET OF PLANS IS THE RESPONSIBILITY OF THE ENGINEER. HOWEVER, THE ENGINEER HAS CONDUCTED VISUAL GENERAL VERIFICATION OF THE LOCATION OF EXISTING UNDERGROUND UTILITIES AND SHOULD BE VERIFIED BY OTHER MEANS.
2. THIS SET OF PLANS HAS BEEN PREPARED FOR THE PURPOSE OF OBTAINING PERMITS AND APPROVALS. THE ENGINEER IS NOT RESPONSIBLE FOR ANY CONDITIONS OR APPROVALS THAT MAY BE REQUIRED BY ANY AGENCIES RESPONSIBLE TO ASSURE THE CONSTRUCTION.
3. DO NOT SCALE DRAWINGS. ALL DIMENSIONS, LOCATIONS, AND ELEVATIONS OF BUILDINGS, STRUCTURES, ETC., SHALL BE AS SHOWN ON THESE PLANS.
4. EXISTING UTILITY INFORMATION CANNOT BE GUARANTEED. THE CONTRACTOR SHALL VERIFY ALL UTILITIES BY CROSSING BY PROPOSED CONSTRUCTION. TO AVOID CONFLICTS, ANY CHANGES TO THE ENGINEERING SHALL BE GIVEN TO THE ENGINEER BEFORE CONSTRUCTION. ANY CHANGES TO THE ENGINEERING SHALL BE GIVEN TO THE ENGINEER BEFORE CONSTRUCTION.
5. FINAL LOCATIONS, NUMBERS, AND SIZES OF ALL UTILITIES SHALL BE VERIFIED WITH THE ARCHITECT.
6. ALL MATERIALS, WORKMANSHIP, AND CONSTRUCTION SHALL BE IN ACCORDANCE WITH:
 - A) PENNSYLVANIA DEPARTMENT OF TRANSPORTATION BRIDGE CONSTRUCTION MANUAL, EDITION 2008.
 - B) CURRENT PREVALENT PRACTICES AND REQUIREMENTS.
 - C) CURRENT PREVALENT PRACTICES AND REQUIREMENTS.
7. THE CONTRACTOR SHALL BE RESPONSIBLE FOR OBTAINING ALL NECESSARY PERMITS AND APPROVALS FROM ALL AGENCIES AND AGENCIES INVOLVED IN THE PROJECT.
8. THE CONTRACTOR IS RESPONSIBLE FOR OBTAINING ALL NECESSARY PERMITS AND APPROVALS FROM ALL AGENCIES AND AGENCIES INVOLVED IN THE PROJECT.
9. THE CONTRACTOR IS RESPONSIBLE FOR OBTAINING ALL NECESSARY PERMITS AND APPROVALS FROM ALL AGENCIES AND AGENCIES INVOLVED IN THE PROJECT.
10. THE CONTRACTOR IS RESPONSIBLE FOR OBTAINING ALL NECESSARY PERMITS AND APPROVALS FROM ALL AGENCIES AND AGENCIES INVOLVED IN THE PROJECT.
11. ALL PROPOSED SPOT ELEVATIONS SHALL BE AS SHOWN ON THESE PLANS.
12. WALKWAYS SHOULD SLOPE AWAY FROM BUILDINGS AND STRUCTURES. CONCRETE SIDEWALKS AND CURBS SHALL BE FINISHED TO A MAXIMUM FINISH GRADE OF 6" BELOW FINISHED GRADE IS HIGHER THAN 6" BELOW FINISHED GRADE.
13. CONCRETE SIDEWALKS AND CURBS SHALL BE FINISHED TO A MAXIMUM FINISH GRADE OF 6" BELOW FINISHED GRADE.
14. THE CONTRACTOR SHALL BE RESPONSIBLE FOR OBTAINING ALL NECESSARY PERMITS AND APPROVALS FROM ALL AGENCIES AND AGENCIES INVOLVED IN THE PROJECT.
15. THE APPLICANT IS TO PROVIDE ALL NECESSARY PERMITS AND APPROVALS WITH ALL RECYCLING REQUIREMENTS.
16. UNITS ARE IN UNITED STATES.
17. EXISTING CONDITIONS HAVE BEEN VERIFIED BY VISUAL GENERAL VERIFICATION. THE ENGINEER HAS CONDUCTED VISUAL GENERAL VERIFICATION OF THE LOCATION OF EXISTING UNDERGROUND UTILITIES AND SHOULD BE VERIFIED BY OTHER MEANS.
18. THIS PLAN DOES NOT REPRESENT ANY OTHER PLANS OR SPECIFICATIONS DATED 02/02/07 AND LAST REVISION 02/02/07.

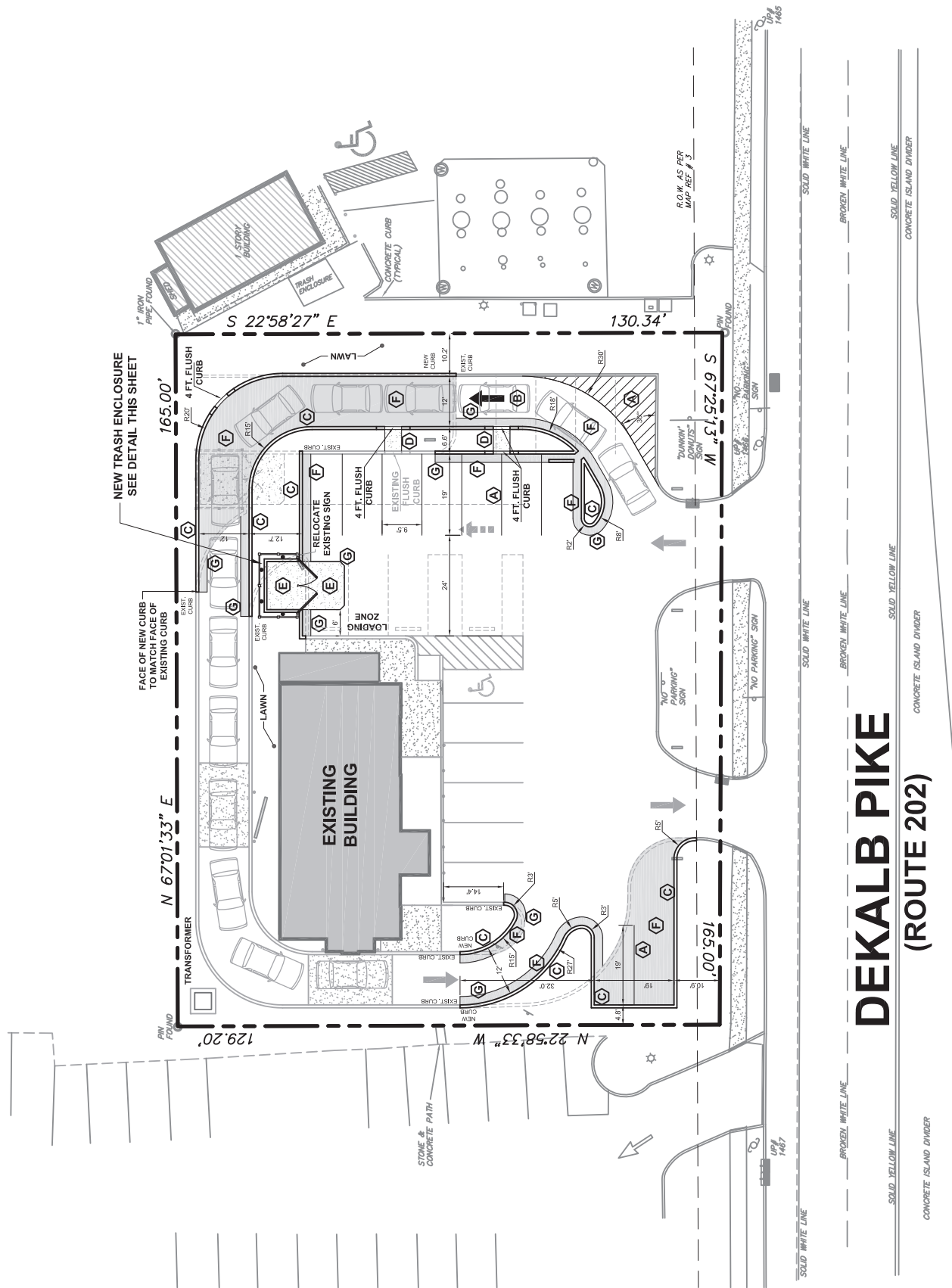

**DEKALB PIKE
(ROUTE 202)**