

DATE:	REVISION:

- NOTES:**
1. THE EXISTING BENNIGAN'S RESTAURANT WILL BE DEMOLISHED UNDER A SEPARATE CONTRACT AND PERMIT. THE DEMOLITION WILL REMOVE THE FRONT AND TWO SIDE WALLS OF THE BUILDING DOWN TO THE TOP OF EXISTING FOUNDATIONS AND EXISTING FLOOR SLAB. THE REAR WALL OF THE BUILDING WILL REMAIN IN PLACE AND INCORPORATED INTO THE NEW BUILDING.
  2. THE PROPOSED RESTAURANT WILL BE CONSTRUCTED ON THE EXISTING PERIMETER WALL FOUNDATIONS WITH NEW INTERNAL FOUNDATIONS AS NEEDED FOR PROPOSED STRUCTURAL ELEMENTS. THE FOOTPRINT OF THE BUILDING WILL REMAIN UNCHANGED.
  3. THERE IS A MINOR RECONFIGURATION OF THE PARKING ALONG WITH LANDSCAPE PLANTERS AND A NEW LANDSCAPED ISLAND. A SERVICE AREA WILL BE CREATED ALONG THE NORTHERLY END OF THE BUILDING FOR DUMPSTERS AND OTHER SERVICE NEEDS.
  4. ASIDE FROM MINOR DISTURBANCE FOR FOUNDATION AND PLANTER CONSTRUCTION, THERE WILL BE NO GENERAL SITE DISTURBANCE. THE PERIMETER CURBING IS GENERALLY BEING MAINTAINED AND, EXCEPT FOR ISLAND CONSTRUCTION, PAVEMENT WILL NOT BE REMOVED. ACCORDINGLY, EARTH DISTURBANCE WILL BE MINIMAL.

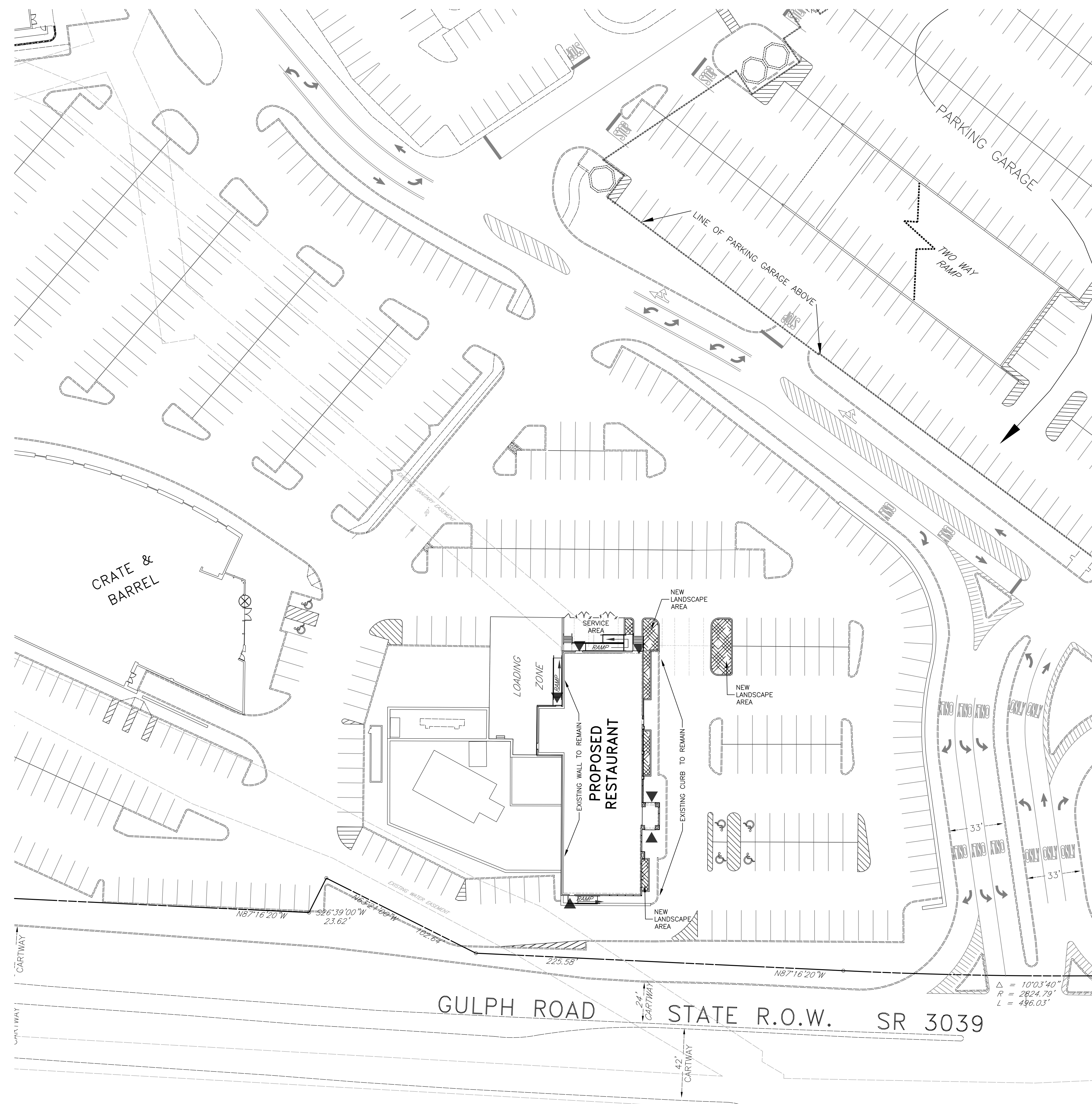

**LEGEND**

- EXISTING PROPERTY
- - - EXISTING EASEMENT
- EXISTING EDGE OF PAVING
- EXISTING BUILDING
- EXISTING SIGNAGE
  
- ▨ PROPOSED LANDSCAPE AREA
- ▬ PROPOSED BUILDING
- ▬ PROPOSED CURB

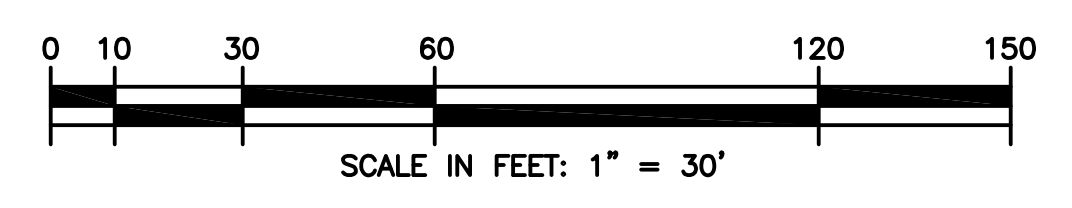
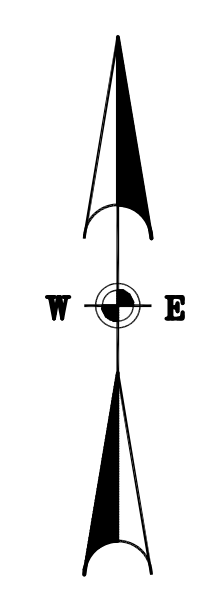

**ADVANCED Geoservices**  
*Engineering for the Environment. Planning for People.™*  
 1055 ANDREW DRIVE, SUITE A  
 WEST CHESTER, PENNSYLVANIA 19380

**PRELIMINARY/FINAL  
 LAND DEVELOPMENT PLAN  
 PROPOSED RESTAURANT**

KING OF PRUSSIA PLAZA  
 UPPER MERION TOWNSHIP  
 MONTGOMERY COUNTY, PENNSYLVANIA

**SITE  
 PLAN  
 C101**

Scale:	1" = 30'
Date:	2/10/2009
Drawn By:	RAJ
Checked By:	SBW
Project Mgr.:	
Project No.:	20082273
Sheet No.:	2 OF 2
Issued:	