

SED SCHEDULE 'X'
 4 lbs./1,000 sq ft.
 10% ONE ESSUE (PERMANENT)
 10% PERMANENT (PERMANENT)
 80% KENTUCKY BLUEGRASS BLEND (USE AT LEAST 3 CULTIVARS)

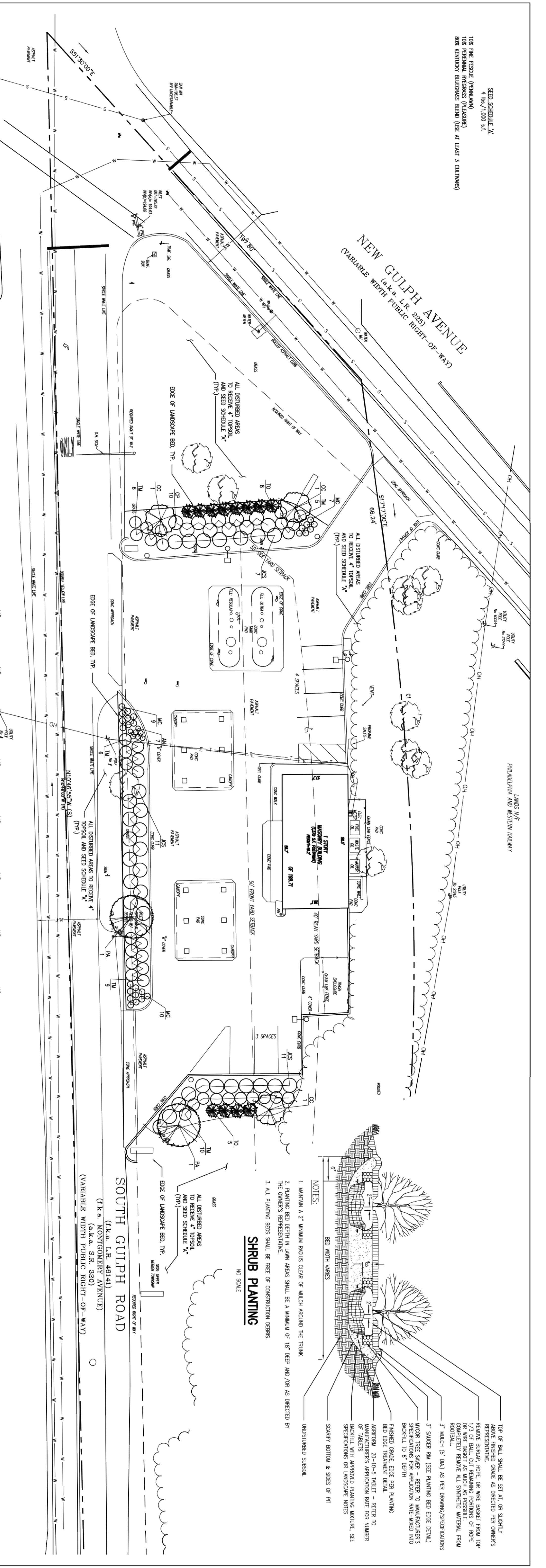

NEW GULPH AVENUE
 (a.k.a. I.R. 255)
 (VARIABLE WIDTH PUBLIC RIGHT-OF-WAY)

LANOS N/E
 PHILADELPHIA AND WESTERN RAILWAY

SOUTH GULPH ROAD
 (I.K.A. L.R. 46141)
 (I.K.A. S.R. 350)
 (VARIABLE WIDTH PUBLIC RIGHT-OF-WAY)

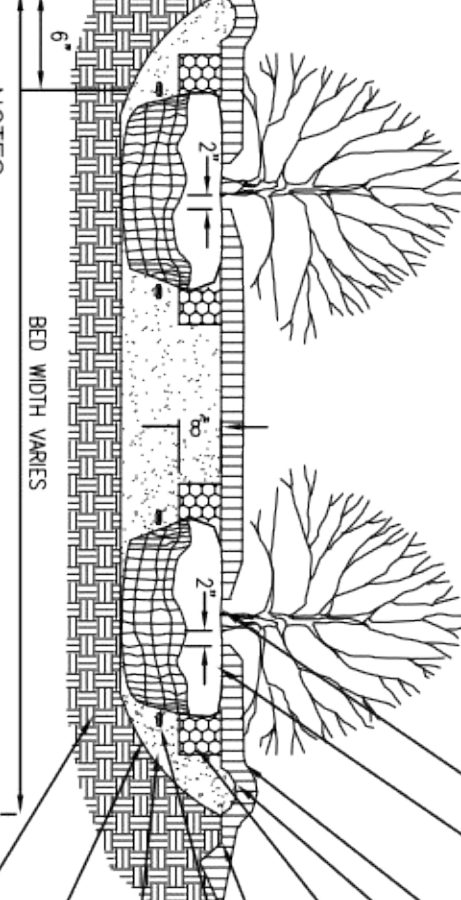

TOP OF BALL SHALL BE SET AT, OR SLIGHTLY ABOVE FINISHED GRADE AS DIRECTED PER OWNER'S REPRESENTATIVE.
 REMOVE BURLAP, TWIG, OR WIRE BASKET FROM TOP OF WIRE BASKET AS MUCH AS POSSIBLE OR COMPLETELY REMOVE ALL SYNTHETIC MATERIAL FROM ROOTBALL.
 3" MULCH (5' DIA.) AS PER DRAWING/SPECIFICATIONS
 3" SACKER BUL (SEE PLANTING BED EDGE DETAIL)
 WIRE MESH SACKER - REFER TO MANUFACTURER'S SPECIFICATIONS FOR APPLICATION RATE-WAIVED INTO BACKFILL TO 8" DEPTH
 FINISHED GRADE EDGE PER PLANTING
 BED EDGE TREATMENT DETAIL
 AGRICULTURE 20-10-5 TABLET - REFER TO MANUFACTURER'S APPLICATION RATE FOR NUMBER OF TABLETS
 BACKFILL WITH APPROVED PLANTING MATERIAL. SEE SPECIFICATIONS FOR LANDSCAPE NOTES

NOTES:
 1. MAINTAIN A 2" MINIMUM ROUNDS CLEAR OF MULCH AROUND THE TRUNK.
 2. PLANTING BED DEPTH IN LANE AREAS SHALL BE A MINIMUM OF 18" DEEP AND /OR AS DIRECTED BY THE OWNER'S REPRESENTATIVE.
 3. ALL PLANTING BERTS SHALL BE FREE OF CONSTRUCTION DEBRIS.

SHRUB PLANTING

LANDSCAPE PLAN

SCALE: 1"=20'
 0 10 20 FT

LANDSCAPE SPECIFICATIONS AND NOTES FOR BARN GARDEN & INTERIOR AREAS

1. PLANTING SOIL SHALL BE WAVED ON-SITE PRIOR TO START OF PLANTING. IT SHALL BE TESTED TO DETERMINE PH, NUTRIENT LEVELS, AND PRESENT LEVELS OF SALINITY. TESTS SHALL BE CONDUCTED AT LEAST TWO (2) FEET BELOW THE FINISHED GRADE. TESTS SHALL BE CONDUCTED AT LEAST TWO (2) FEET BELOW THE FINISHED GRADE. TESTS SHALL BE CONDUCTED AT LEAST TWO (2) FEET BELOW THE FINISHED GRADE. TESTS SHALL BE CONDUCTED AT LEAST TWO (2) FEET BELOW THE FINISHED GRADE.

INSPECTIONS

REGULAR INSPECTIONS SHALL BE MADE DURING THE FOLLOWING STAGES OF CONSTRUCTION:
 1. SOIL
 2. UPON COMPLETION OF FINAL GRADING AND ESTABLISHMENT OF FIRMAMENT STABILIZATION.
 3. BARN GARDEN SHALL NOT BE CONSTRUCTED UNTIL THE EROSION CONTROL PLAN FOR MOST DETAIL.
 4. MULCH SHALL CONSIST OF SPREADDED HAYSTACK AND SHALL BE APPLIED AT LEAST 6 MONTHS PRIOR TO APPLICATION. NO PINE OR CEDAR MULCH SHALL BE USED. MULCH SHALL BE APPLIED TO THE MULCH IS IMPORTANT IN POLLUTION REDUCTION, MAINTAINING SOIL MOISTURE, AND IN PREVENTING EROSION.

PLANT LIST

KEY	QTY	SPECIES NAME	COMMON NAME	INSTALLATION SIZE	WATER SIZE	CONDITION	SPACING
KT	01	Shade Tree	Shade Tree	24"	50-60"	As Shown	As Shown
KT	02	Flowering Tree	Flowering Tree	24"	50-60"	As Shown	As Shown
KT	03	Shrub	Shrub	12-15"	12-15"	As Shown	As Shown
KT	04	Shrub	Shrub	12-15"	12-15"	As Shown	As Shown
KT	05	Shrub	Shrub	12-15"	12-15"	As Shown	As Shown
KT	06	Shrub	Shrub	12-15"	12-15"	As Shown	As Shown
KT	07	Shrub	Shrub	12-15"	12-15"	As Shown	As Shown
KT	08	Shrub	Shrub	12-15"	12-15"	As Shown	As Shown
KT	09	Shrub	Shrub	12-15"	12-15"	As Shown	As Shown
KT	10	Shrub	Shrub	12-15"	12-15"	As Shown	As Shown
KT	11	Shrub	Shrub	12-15"	12-15"	As Shown	As Shown
KT	12	Shrub	Shrub	12-15"	12-15"	As Shown	As Shown
KT	13	Shrub	Shrub	12-15"	12-15"	As Shown	As Shown
KT	14	Shrub	Shrub	12-15"	12-15"	As Shown	As Shown
KT	15	Shrub	Shrub	12-15"	12-15"	As Shown	As Shown
KT	16	Shrub	Shrub	12-15"	12-15"	As Shown	As Shown
KT	17	Shrub	Shrub	12-15"	12-15"	As Shown	As Shown
KT	18	Shrub	Shrub	12-15"	12-15"	As Shown	As Shown
KT	19	Shrub	Shrub	12-15"	12-15"	As Shown	As Shown
KT	20	Shrub	Shrub	12-15"	12-15"	As Shown	As Shown
KT	21	Shrub	Shrub	12-15"	12-15"	As Shown	As Shown
KT	22	Shrub	Shrub	12-15"	12-15"	As Shown	As Shown
KT	23	Shrub	Shrub	12-15"	12-15"	As Shown	As Shown
KT	24	Shrub	Shrub	12-15"	12-15"	As Shown	As Shown
KT	25	Shrub	Shrub	12-15"	12-15"	As Shown	As Shown
KT	26	Shrub	Shrub	12-15"	12-15"	As Shown	As Shown
KT	27	Shrub	Shrub	12-15"	12-15"	As Shown	As Shown
KT	28	Shrub	Shrub	12-15"	12-15"	As Shown	As Shown
KT	29	Shrub	Shrub	12-15"	12-15"	As Shown	As Shown
KT	30	Shrub	Shrub	12-15"	12-15"	As Shown	As Shown

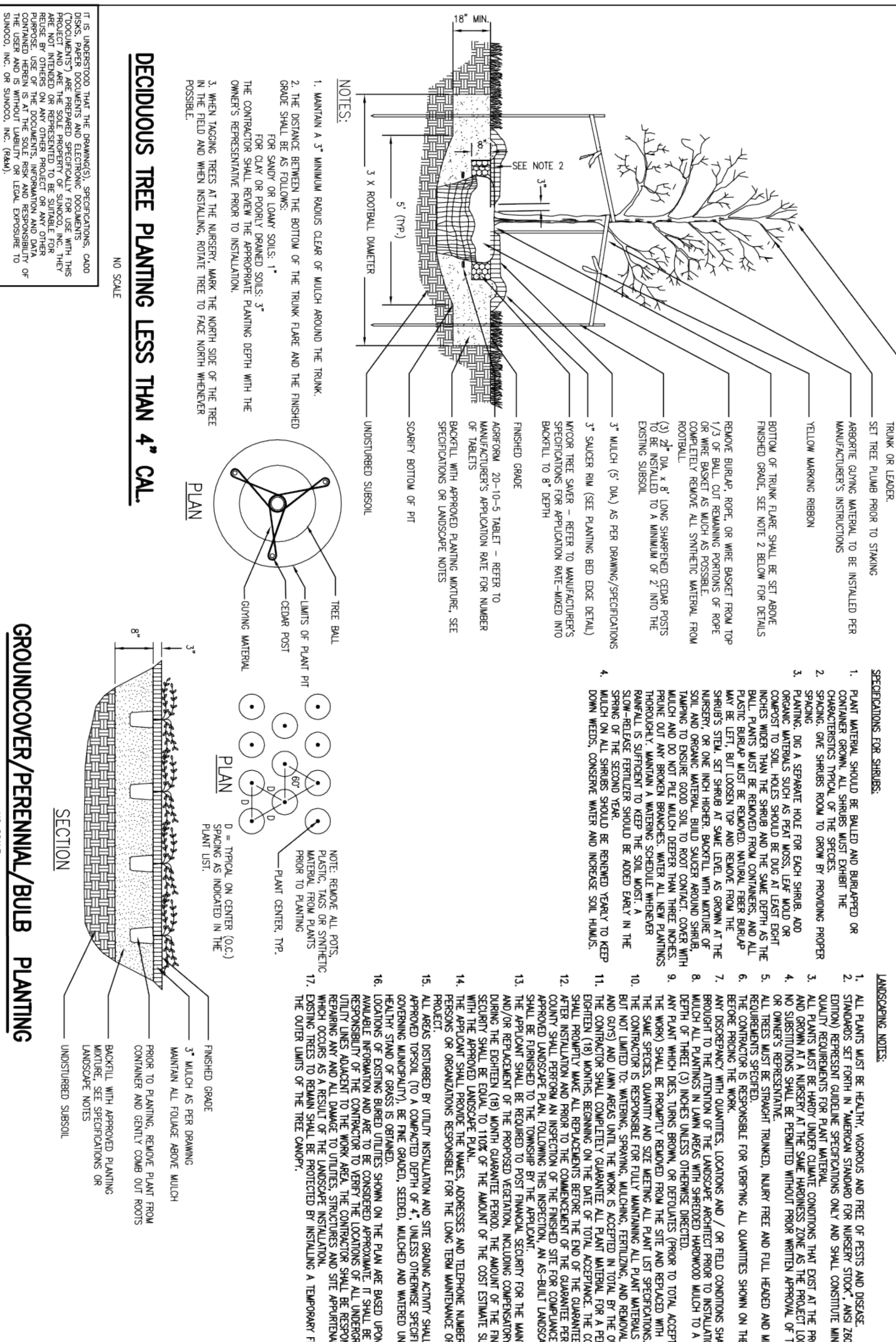

NOTES:
 1. MAINTAIN A 2" MINIMUM ROUNDS CLEAR OF MULCH AROUND THE TRUNK.
 2. PLANTING BED DEPTH IN LANE AREAS SHALL BE A MINIMUM OF 18" DEEP AND /OR AS DIRECTED BY THE OWNER'S REPRESENTATIVE.
 3. ALL PLANTING BERTS SHALL BE FREE OF CONSTRUCTION DEBRIS.

DECIDUOUS TREE PLANTING LESS THAN 4" CAL

NO SCALE

1. MAINTAIN A 2" MINIMUM ROUNDS CLEAR OF MULCH AROUND THE TRUNK.
 2. THE DISTANCE BETWEEN THE BOTTOM OF THE TRUNK FLARE AND THE FINISHED GRADE SHALL BE SUFFICIENT TO ACCOMMODATE THE ROOT BALL.
 3. WHEN LOCATING TREES AT THE NURSERY, MARK THE NORTH SIDE OF THE TREE IN THE FIELD AND WHEN INSTALLING, ROTATE TREE TO FACE NORTH WHEDEVER POSSIBLE.

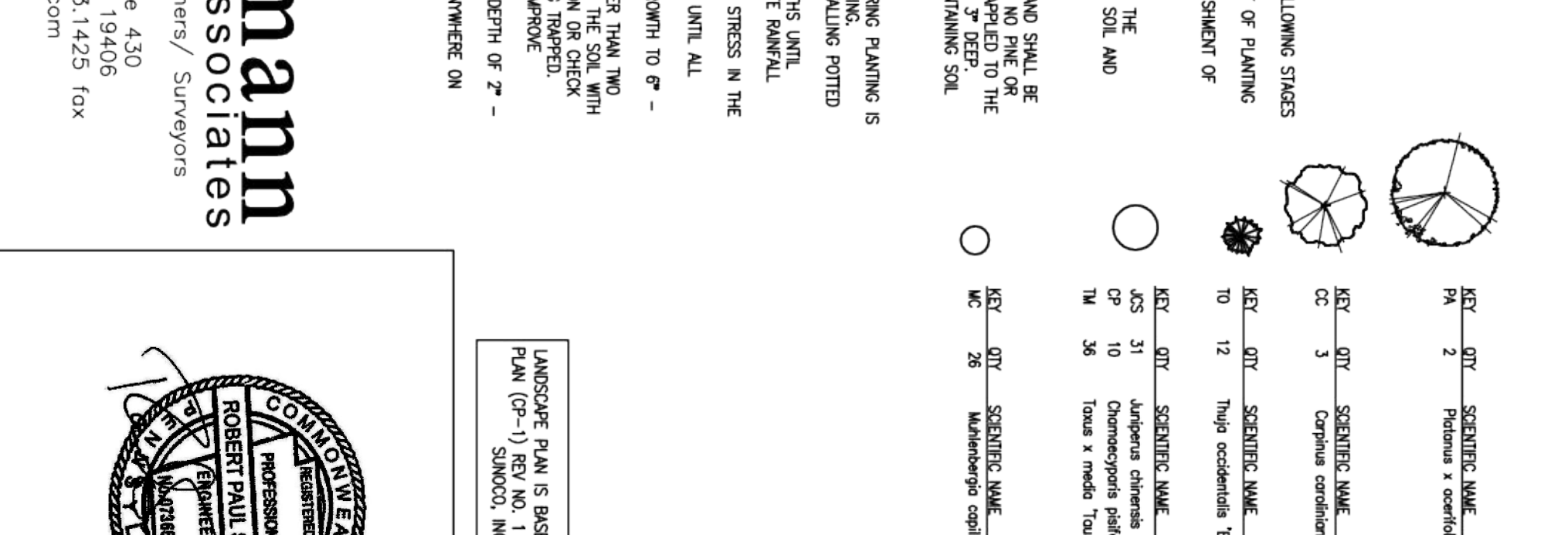

GROUNDCOVER/PERENNIAL/BULB PLANTING

NO SCALE

1. MAINTAIN A 2" MINIMUM ROUNDS CLEAR OF MULCH AROUND THE TRUNK.
 2. THE DISTANCE BETWEEN THE BOTTOM OF THE TRUNK FLARE AND THE FINISHED GRADE SHALL BE SUFFICIENT TO ACCOMMODATE THE ROOT BALL.
 3. WHEN LOCATING TREES AT THE NURSERY, MARK THE NORTH SIDE OF THE TREE IN THE FIELD AND WHEN INSTALLING, ROTATE TREE TO FACE NORTH WHEDEVER POSSIBLE.

CALL BEFORE YOU DIG!

8 INCHES MINIMUM DEPTH REQUIRED FOR ALL UTILITY LINES.

CONSTRUCTION PHASE AND TO WORKING DAYS IN DESIGN STAGE - STOP CALL

PENNSYLVANIA ONE CALL SYSTEM, INC.

SERIAL # XXXXXXXXXX

1-800-242-1776

Bergmann Associates

Engineers / Architects / Planners / Surveyors

1040 First Ave, Suite 430
 King of Prussia, PA 19406
 610.783.1420 / 610.783.1425 fax
 www.bergmannpc.com

LANDSCAPE PLAN

PROJECT NO. 98754.00

LOCATION: 1308 SOUTH GULPH ROAD, GULPH MILLS, PA, MONTGOMERY COUNTY

CLIENT: STINOCO, INC., Retail Engineering Gulph Mills, PA

DATE: 12/21/2010

APPROVED: RFS
 CHECKED: TED
 DATE: 12/21/2010

FACILITY NO. 0029-8822

DRAWING NO. **LS-1**

SCALE

REV. NO. 0